

175

GRAND PRIX FARMS, PLAT NO. 1, P.R.D., REPLAT NO. 3  
BEING A REPLAT OF LOTS 50, 54, 55, 57, AND 58, GRAND PRIX FARMS, PLAT NO. 1, P.R.D.,  
AS RECORDED IN PLAT BOOK 67, PAGES 14 THROUGH 17  
OF THE PUBLIC RECORDS OF PALM BEACH COUNTY, FLORIDA  
LYING IN THE WEST ONE HALF OF SECTION 20, TOWNSHIP 44 SOUTH, RANGE 41 EAST,  
VILLAGE OF WELLINGTON, FLORIDA  
SHEET 1 OF 2 SHEETS  
SEPTEMBER 1997

DEDICATION AND DESCRIPTION

KNOW ALL MEN BY THESE PRESENTS THAT BELLE HERBE FARM INCORPORATED, A NEW YORK CORPORATION, ANNE MEYER, M. ANTHONY FISHER AND STADIUM JUMPING, INCORPORATED, OWNERS OF THE LAND SHOWN HEREON, BEING IN SECTION 20, TOWNSHIP 44 SOUTH, RANGE 41 EAST, VILLAGE OF WELLINGTON, FLORIDA, SHOWN HEREON AS GRAND PRIX FARMS, PLAT No 1 P.R.D., REPLAT No. 3, BEING A REPLAT OF LOTS 50, 54, 55, 57 AND 58, GRAND PRIX FARMS, PLAT No. 1, P.R.D., AS RECORDED IN PLAT BOOK 67, PAGES 14 THROUGH 17 OF THE PUBLIC RECORDS OF PALM BEACH COUNTY, FLORIDA, BEING MORE PARTICULARLY DESCRIBED AS FOLLOWS:

LOTS 50, 54, 55, 57 AND 58, GRAND PRIX FARMS, PLAT NO. 1, P.R.D., ACCORDING TO THE PLAT THEREOF, AS RECORDED IN PLAT BOOK 67, PAGES 14 THROUGH 17 OF THE PUBLIC RECORDS OF PALM BEACH COUNTY, FLORIDA.

CONTAINING: 16.9 ACRES MORE OR LESS.  
HAVE CAUSED THE SAME TO BE SURVEYED AND PLATTED AS SHOWN HEREON AND DO HEREBY DEDICATE AS FOLLOWS:

TRACT "A", AS SHOWN HEREON IS HEREBY RESERVED FOR BELLE HERBE FARM INCORPORATED, A NEW YORK CORPORATION, ITS SUCCESSORS AND ASSIGNS, FOR EQUESTRIAN DEVELOPMENT AND OTHER PROPER PURPOSES.

TRACT "B", AS SHOWN HEREON IS HEREBY RESERVED FOR M. ANTHONY FISHER AND ANNE E. FISHER, THEIR SUCCESSORS AND ASSIGNS, FOR EQUESTRIAN DEVELOPMENT AND OTHER PROPER PURPOSES.

TRACT "C", AS SHOWN HEREON IS HEREBY RESERVED FOR STADIUM JUMPING, INC., A FLORIDA CORPORATION, ITS SUCCESSORS AND ASSIGNS, FOR EQUESTRIAN DEVELOPMENT AND OTHER PROPER PURPOSES.

TRACT "D", AS SHOWN HEREON IS HEREBY RESERVED FOR ANNE MEYER, HER SUCCESSORS AND ASSIGNS, FOR EQUESTRIAN DEVELOPMENT AND OTHER PROPER PURPOSES.

IN WITNESS WHEREOF, WE BELLE HERBE FARM INCORPORATED, A NEW YORK CORPORATION, ANNE MEYER, M. ANTHONY FISHER AND ANNE E. FISHER, AND STADIUM JUMPING, INC., A FLORIDA CORPORATION, HAVE EXECUTED THE PLAT SHOWN HEREON THIS 19th DAY OF FEBRUARY, 1998.

WITNESS: [Signature] BY: [Signature]  
HOWARD A. NEWMAN, PRESIDENT

WITNESS: [Signature] BY: [Signature]  
ANNE MEYER

WITNESS: [Signature] BY: [Signature]  
M. ANTHONY FISHER

WITNESS: [Signature] BY: [Signature]  
ANNE E. FISHER

WITNESS: [Signature] BY: [Signature]  
EUGENE MISCHE, PRESIDENT

ACKNOWLEDGEMENTS

STATE OF FLORIDA  
COUNTY OF PALM BEACH  
BEFORE ME PERSONALLY APPEARED HOWARD A. NEWMAN WHO IS PERSONALLY KNOWN TO ME, AND WHO EXECUTED THE FOREGOING INSTRUMENT AS PRESIDENT OF BELLE HERBE FARMS, INCORPORATED, A NEW YORK CORPORATION, AND SEVERALLY ACKNOWLEDGED TO AND BEFORE ME THAT HE EXECUTED SUCH INSTRUMENT AS SUCH OFFICER OF SAID CORPORATION, AND THAT THE SEAL AFFIXED TO THE FOREGOING INSTRUMENT IS THE CORPORATE SEAL OF SAID CORPORATION AND THAT IT WAS AFFIXED TO SAID INSTRUMENT BY DUE AND REGULAR CORPORATE AUTHORITY, AND THAT SAID INSTRUMENT IS THE FREE ACT AND DEED OF SAID CORPORATION.

WITNESS MY HAND AND OFFICIAL SEAL THIS 19th DAY OF FEBRUARY, 1998.  
MY COMMISSION EXPIRES: 10-17-98

STATE OF FLORIDA  
COUNTY OF PALM BEACH  
BEFORE ME PERSONALLY APPEARED ANNE MEYER WHO IS PERSONALLY KNOWN TO ME, AND WHO EXECUTED THE FOREGOING INSTRUMENT AND ACKNOWLEDGED BEFORE ME THAT SHE EXECUTED SAID INSTRUMENT FOR THE PURPOSES EXPRESSED THEREIN.

WITNESS MY HAND AND OFFICIAL SEAL THIS 28th DAY OF JANUARY, 1998.  
MY COMMISSION EXPIRES: 10-17-98

STATE OF FLORIDA  
COUNTY OF PALM BEACH  
BEFORE ME PERSONALLY APPEARED ANNE MEYER WHO IS PERSONALLY KNOWN TO ME, AND WHO EXECUTED THE FOREGOING INSTRUMENT AND ACKNOWLEDGED BEFORE ME THAT SHE EXECUTED SAID INSTRUMENT FOR THE PURPOSES EXPRESSED THEREIN.

STATE OF FLORIDA  
COUNTY OF PALM BEACH

BEFORE ME PERSONALLY APPEARED M. ANTHONY FISHER AND ANNE E. FISHER WHO ARE PERSONALLY KNOWN TO ME, AND WHO EXECUTED THE FOREGOING INSTRUMENT, AND ACKNOWLEDGED BEFORE ME THAT THEY EXECUTED SAID INSTRUMENT FOR THE PURPOSES EXPRESSED THEREIN.

WITNESS MY HAND AND OFFICIAL SEAL THIS 1st DAY OF FEBRUARY, 1998.  
MY COMMISSION EXPIRES: 10-17-98

STATE OF FLORIDA  
COUNTY OF PALM BEACH

BEFORE ME PERSONALLY APPEARED EUGENE MISCHE WHO IS PERSONALLY KNOWN TO ME, AND WHO EXECUTED THE FOREGOING INSTRUMENT AS PRESIDENT OF STADIUM JUMPING, INC., A FLORIDA CORPORATION, AND SEVERALLY ACKNOWLEDGED TO AND BEFORE ME THAT HE EXECUTED SUCH INSTRUMENT AS SUCH OFFICER OF SAID CORPORATION, AND THAT THE SEAL AFFIXED TO THE FOREGOING INSTRUMENT IS THE CORPORATE SEAL OF SAID CORPORATION AND THAT IT WAS AFFIXED TO SAID INSTRUMENT BY DUE AND REGULAR CORPORATE AUTHORITY, AND THAT SAID INSTRUMENT IS THE FREE ACT AND DEED OF SAID CORPORATION.

WITNESS MY HAND AND OFFICIAL SEAL THIS 28th DAY OF JANUARY, 1998.  
MY COMMISSION EXPIRES: 10-17-98

TITLE CERTIFICATION

STATE OF FLORIDA  
COUNTY OF PALM BEACH

I, HILDA M. PORRO, A DULY LICENSED ATTORNEY IN THE STATE OF FLORIDA DO HEREBY CERTIFY THAT I HAVE EXAMINED THE TITLE TO THE HEREON DESCRIBED PROPERTY; THAT I FIND THE TITLE TO THE PROPERTY IS VESTED TO BELLE HERBE FARMS, INCORPORATED, A NEW YORK CORPORATION, ANNE MEYER, M. ANTHONY FISHER AND ANNE E. FISHER, AND STADIUM JUMPING, INC., A FLORIDA CORPORATION THERE ARE NO MORTGAGES OF RECORD; AND THAT THERE ARE ENCUMBRANCES OF RECORD BUT THOSE ENCUMBRANCES DO NOT PROHIBIT THE CREATION OF THE SUBDIVISION DEPICTED BY THIS PLAT.

DATED: 1-28-98  
HILDA M. PORRO

APPROVALS

STATE OF FLORIDA  
COUNTY OF PALM BEACH

THE VILLAGE OF WELLINGTON, ITS SUCCESSORS AND ASSIGNS, HEREBY APPROVES THE PLAT AND ACCEPTS THE DEDICATION TO SAID VILLAGE OF WELLINGTON AS SHOWN HEREON, DATED THIS 9th DAY OF JUNE, 1998.

BY: [Signature]  
CARMINE A. PRIORE, DDJ, MAYOR

ATTEST: [Signature]  
AWILDA RODRIGUEZ, VILLAGE CLERK

ACKNOWLEDGMENT

STATE OF FLORIDA  
COUNTY OF PALM BEACH

BEFORE ME PERSONALLY APPEARED CARMINE A. PRIORE, DDJ, AND AWILDA RODRIGUEZ, WHO ARE PERSONALLY KNOWN TO ME, AND WHO EXECUTED THE FOREGOING INSTRUMENT AS MAYOR AND VILLAGE CLERK OF THE VILLAGE OF WELLINGTON, A POLITICAL SUBDIVISION OF THE STATE OF FLORIDA, AND SEVERALLY ACKNOWLEDGED TO AND BEFORE ME THAT THEY EXECUTED SUCH INSTRUMENT AS SUCH OFFICERS OF SAID VILLAGE, AND THAT THE SEAL AFFIXED TO THE FOREGOING INSTRUMENT IS THE VILLAGE SEAL OF SAID VILLAGE AND THAT IT WAS AFFIXED TO SAID INSTRUMENT BY DUE AND REGULAR AUTHORITY, AND THAT SAID INSTRUMENT IS THE FREE ACT AND DEED OF SAID VILLAGE.

WITNESS MY HAND AND OFFICIAL SEAL THIS 9th DAY OF JUNE, 1998.  
MY COMMISSION EXPIRES: April 12, 1999

STATE OF FLORIDA  
COUNTY OF PALM BEACH  
BEFORE ME PERSONALLY APPEARED ANNE MEYER WHO IS PERSONALLY KNOWN TO ME, AND WHO EXECUTED THE FOREGOING INSTRUMENT AND ACKNOWLEDGED BEFORE ME THAT SHE EXECUTED SAID INSTRUMENT FOR THE PURPOSES EXPRESSED THEREIN.

WITNESS MY HAND AND OFFICIAL SEAL THIS 28th DAY OF JANUARY, 1998.  
MY COMMISSION EXPIRES: 10-17-98

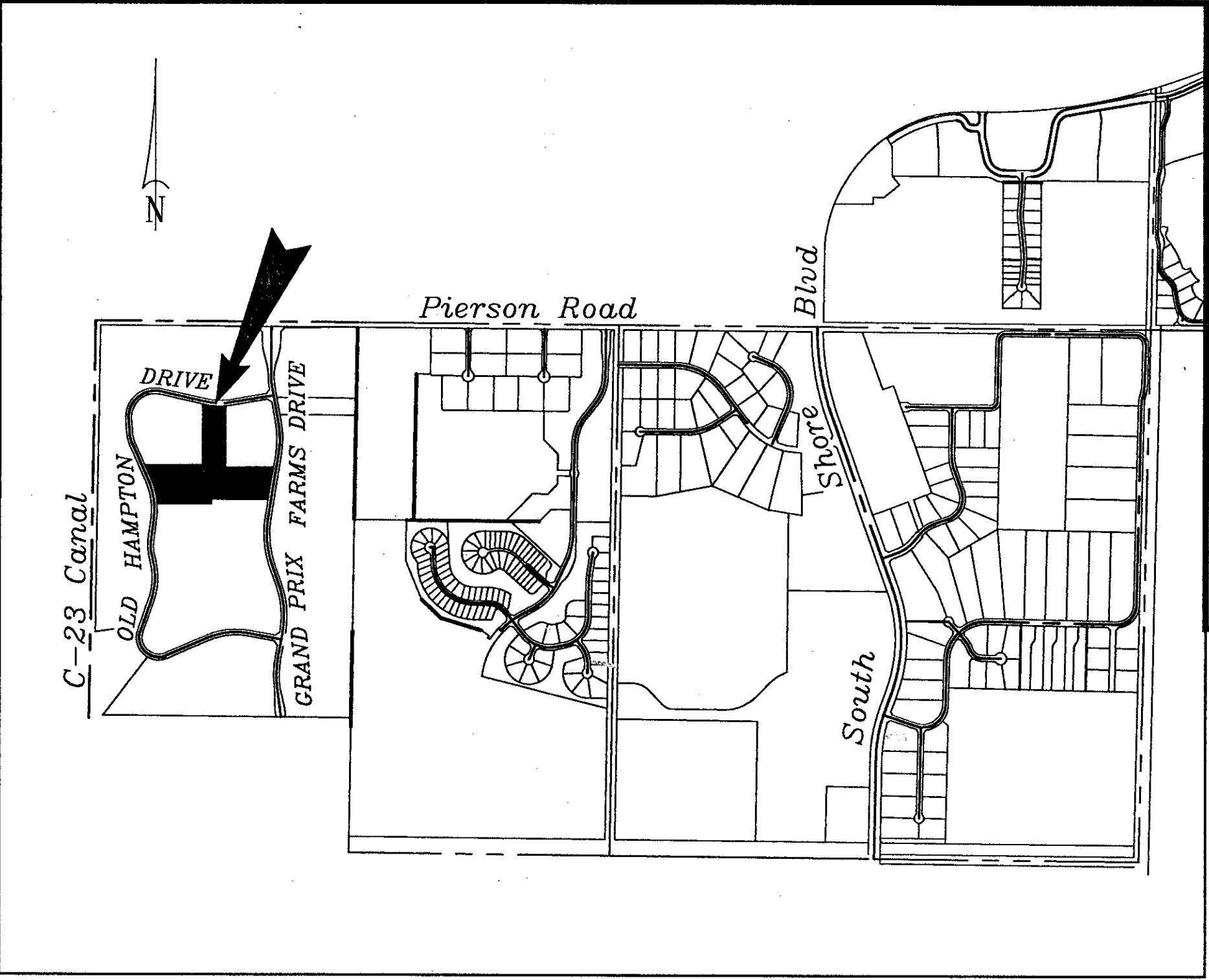

LOCATION MAP (NOT TO SCALE)

SURVEYOR'S NOTES

- 1. PLAT POSITION AND ORIENTATION
A. COORDINATES SHOWN ARE GRID
B. DATUM = NORTH AMERICAN DATUM (NAD) OF 1983, 1990 ADJUSTMENT
C. ZONE = FLORIDA EAST
D. LINEAR UNIT = U.S. SURVEY FOOT
E. COORDINATE SYSTEM = 1983 STATE PLANE TRANSVERSE MERCATOR PROJECTION
F. ALL DISTANCES ARE GROUND
G. SCALE FACTOR = 1.0000036
H. ROTATION TO GRID NORTH
N 79° 29' 16" W (PLAT BEARING) 01° 00' 48" CLOCKWISE
N 78° 28' 28" W (GRID BEARING) ROTATION (PLAT TO GRID)
2. PERMANENT REFERENCE MONUMENTS ARE SHOWN THUS: [Symbol] P.L.S. 4828
3. THE BEARINGS SHOWN HEREON ARE REFERENCED TO A BEARING OF S 77° 04' 56" E ALONG THE CENTERLINE OF OLDE HAMPTON DRIVE AS SHOWN ON GRAND PRIX FARMS PLAT No. 1, P.R.D., AS RECORDED IN PLAT BOOK 67, PAGES 14-17 OF THE PUBLIC RECORDS OF PALM BEACH COUNTY, FLORIDA.
4. BUILDING SETBACK LINES SHALL BE AS REQUIRED BY VILLAGE OF WELLINGTON ZONING REGULATIONS.
5. "NOTICE" THERE MAY BE ADDITIONAL RESTRICTIONS THAT ARE NOT RECORDED ON THIS PLAT THAT MAY BE FOUND IN THE PUBLIC RECORDS OF PALM BEACH COUNTY, FLORIDA.
6. ALL LINES ARE NON-RADIAL UNLESS OTHERWISE NOTED.

SURVEYOR'S CERTIFICATE

THIS IS TO CERTIFY THAT THE PLAT SHOWN HEREON IS A TRUE AND CORRECT REPRESENTATION OF A SURVEY MADE UNDER MY RESPONSIBLE DIRECTION AND SUPERVISION; THAT SAID SURVEY IS ACCURATE TO THE BEST OF MY KNOWLEDGE AND BELIEF; THAT PERMANENT REFERENCE MONUMENTS ("P.R.M.'s") HAVE BEEN PLACED AS REQUIRED BY LAW; AND, FURTHER, THAT THE SURVEY DATA COMPLIES WITH ALL THE REQUIREMENTS OF CHAPTER 177, FLORIDA STATUTES, AS AMENDED, AND THE ORDINANCES OF THE VILLAGE OF WELLINGTON.

4/3/98 [Signature]
GARY A. RAGER
PROFESSIONAL SURVEYOR AND MAPPER
CERTIFICATE NO. 4828
STATE OF FLORIDA

THIS INSTRUMENT WAS PREPARED BY GARY A. RAGER IN THE OFFICES OF NICK MILLER, INC., 2560 RCA BLVD., SUITE 105, PALM BEACH GARDENS, FLORIDA, 33410

COUNTY OF PALM BEACH ss
STATE OF FLORIDA
This Plat was filed for record at 9:21 AM
this 26 day of June 1998
and duly recorded in Plat Book No. 82
on page 175-174
Dorothy H. Wilken, Clerk of Circuit Court
by [Signature] D.C.



PET. 89-124
5/2/4/G

VILLAGE OF WELLINGTON
14000 GREENBRIAR BLVD.
WELLINGTON, FLORIDA 33414
(561) 791-4000

82/175

GRAND PRIX FARMS, PLAT NO. 1, P.R.D., REPLAT NO. 3
NICK MILLER, INC.
Surveying & Mapping Consultants
SHEET NO. 1 OF 2
SCALE:
DATE: SEPT. 1997
JOB NO. 97006B
FILE: 97006B.DWG

Subdivision \* Grand Prix Farms
BOOK 82 PAGE 175
FLOOD ZONE A-0 FLOOD MAP #1005
QUAD # 78 ZONING RE
SE 76-00 ZIP CODE 33414
PUD NAME Grand Prix Farms

0581-0005